

**FBO TERMINAL FACILITY CONCEPTUAL DESIGN**  
*Victorville, California*

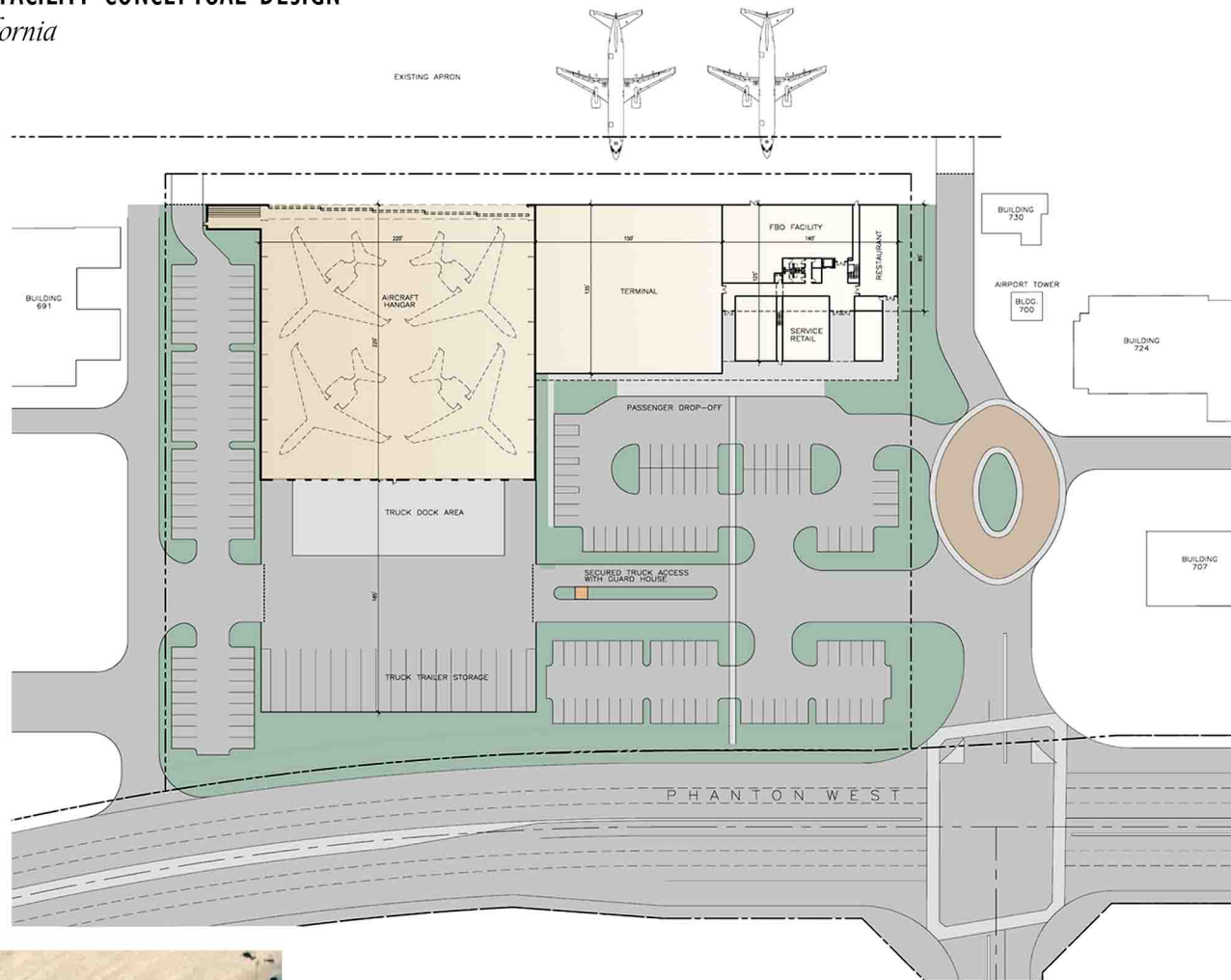

CLIENT: Stirling Enterprises / City of Victorville

DESCRIPTION: Design of FBO facility, hangars (4 Gulfstream V Aircraft), terminal, retail and office use totaling 108,000 square feet on 6.4 acres.